

Scale of 50 to the Inch.

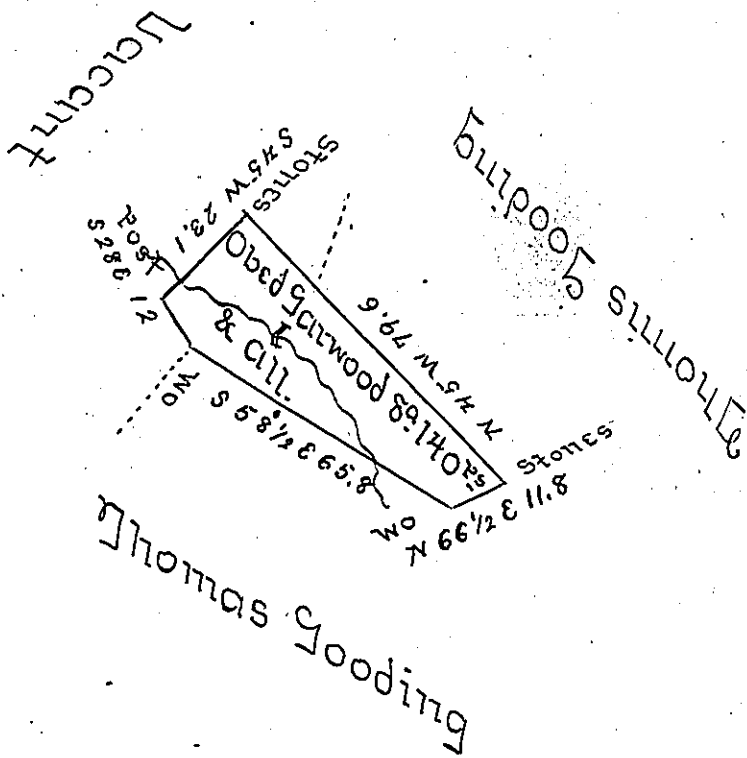

Situate on a Branch of Rushy Run in Luzerne Township  
 Fayette County & Surveyed the 20<sup>th</sup> day of April 1791  
 In pursuance of a Warrant Dated the 8<sup>th</sup> day of Dec-  
 ember 1789.

PE Alexander McClean Deputy

To Daniel Brodhead Esquire  
 Surveyor General -

*IN TESTIMONY* that the above is a copy of the original remaining on file in  
 the Department of Internal Affairs of Pennsylvania, made  
 conformably to an Act of Assembly approved the 16th day of  
 February, 1833, I have hereunto set my Hand and caused  
 the Seal of said Department to be affixed at Harrisburg,  
 this first day of February 1905.

*John A. P. ...*  
 Secretary of Internal Affairs.